

Brand: Levitaz
Model: Frontwing R5
Year: 2020

Measurement Date	Registered	IKA Tolerance	IKA Min	IKA Max
Order Number				
Worker				
Serial No.				
Mold Number				
Status				
Weight Frontwing [g]	560 +/-	5,0 %	532	588
Weight Frontwing incl. Steel Box [g]	1240 +/-	5,0 %	1178	1302
Frontwing a (max span) in mm	725,1 +/-	1,0 mm	724,1	726,1
Frontwing c (chord AA) in mm	85,4 -	1,0 mm	84,4	85,4
Frontwing d (max profile A-A) in mm	11 +/-	0,5 mm	10,5	11,5
Frontwing e (profile depth AA) in mm	33 +/-	1,0 mm	32	34
Frontwing f (chord B-B) in mm	69,8 -	1,0 mm	68,8	69,8
Frontwing g (max profile B-B) in mm	8,1 +/-	0,5 mm	7,6	8,6
Frontwing h (profile depth B-B) in mm	27,4 +/-	1,0 mm	26,4	28,4
Frontwing i (wing height A-A) in mm	22,1 +/-	1,0 mm	21,1	23,1
Frontwing j (wing height A-A) in mm	21,3 +/-	1,0 mm	20,3	22,3
Frontwing k (leading edge) in mm	22,5 +/-	1,0 mm	21,5	23,5
Frontwing l (trailing edge) in mm	21 +/-	1,0 mm	20	22

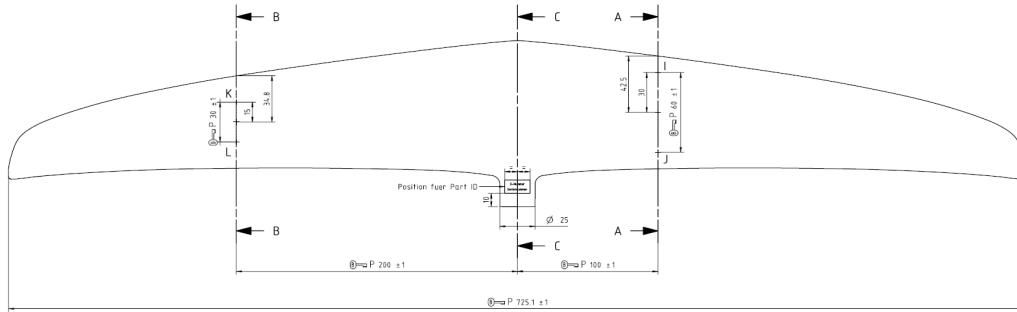

Schnitt / Section A-A

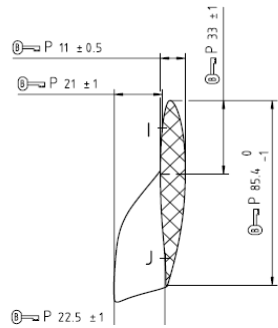

Schnitt / Section B-B

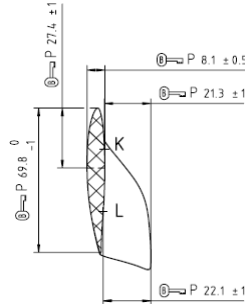

G446870ugd001_d