

Brand: Airush
 Model: Gold
 Year: 2020

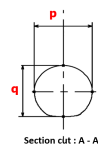
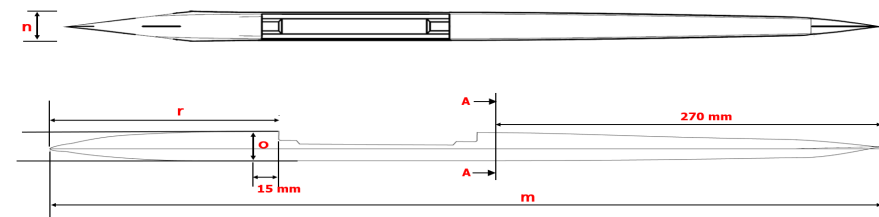
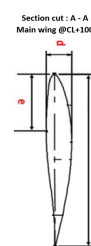
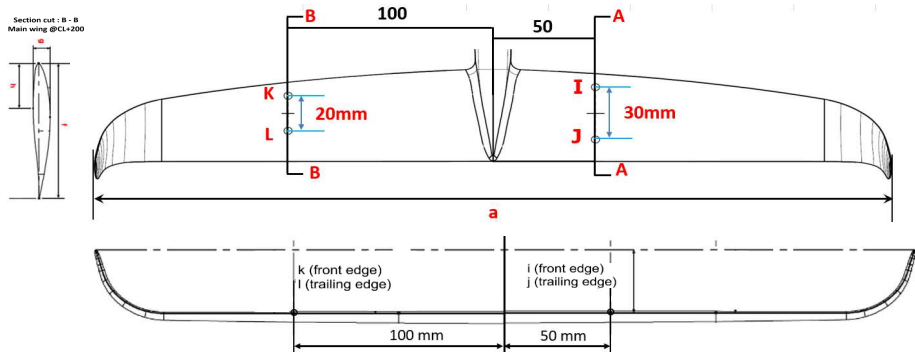
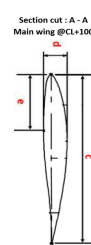
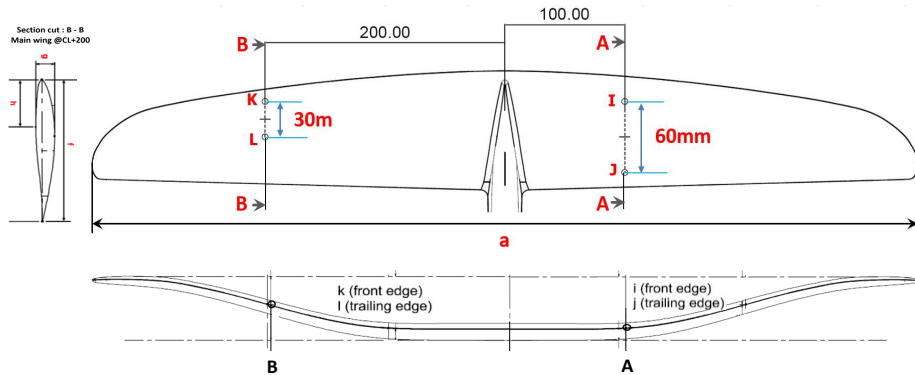

Measurement	Registered	IKA Tolerance	IKA Min	IKA Max
Date				
Order Number				
Laminate name's				
Assembly name's				
Serial No.				
Mold Number				
Status				
Weight Frontwing [g]	+/-	5 %	0,00	0,00
Frontwing a (max span) in mm	700,00 +/-	1 mm	699,00	701,00
Frontwing c (chord AA) in mm	95,80 -	1 mm	94,80	95,80
Frontwing d (max profile A-A) in mm	11,30 +/-	0,5 mm	10,80	11,80
Frontwing e (profile depth A-A) in mm			27,20	37,30
Frontwing f (chord B-B) in mm	82,10 -	1 mm	81,10	82,10
Frontwing g (max profile B-B) in mm	10,70 +/-	0,5 mm	10,20	11,20
Frontwing h (profile depth B-B) in mm			23,00	32,40
Frontwing i (wing height A-A) in mm	61,10 +/-	1 mm	60,10	62,10
Frontwing j (wing height A-A) in mm	63,40 +/-	1 mm	62,40	64,40
Frontwing k (leading edge) in mm	77,00 +/-	1 mm	76,00	78,00
Frontwing l (trailing edge) in mm	78,60 +/-	1 mm	77,60	79,60
Weight Rearwing [g]	+/-	5 %	0,00	0,00
Rearwing a (max span) in mm	370,50 +/-	1 mm	369,50	371,50
Rearwing c (chord AA) in mm	56,10 -	1 mm	55,10	56,10
Rearwing d (max profile A-A) in mm	6,90 +/-	0,5 mm	6,40	7,40
Rearwing e (profile depth A-A) in mm			17,80	23,90
Rearwing f (chord B-B) in mm	50,10 -	1 mm	49,10	50,10
Rearwing g (max profile B-B) in mm	6,20 +/-	0,5 mm	5,70	6,70
Rearwing h (profile depth B-B) in mm			15,70	21,50
Rearwing i (wing height A-A) in mm	64,00 +/-	1 mm	63,00	65,00
Rearwing j (wing height A-A) in mm	64,50 +/-	1 mm	63,50	65,50
Rearwing k (leading edge) in mm	63,50 +/-	1 mm	62,50	64,50
Rearwing l (trailing edge) in mm	64,20 +/-	1 mm	63,20	65,20
Weight Fuselage [g]	+/-	5 %	0,00	0,00
Fuselage m (max span) in mm	575,00 +/-	2 mm	573,00	577,00
Fuselage n (max width) in mm	28,60 +/-	0,5 mm	28,10	29,10
Fuselage o (max height) in mm	32,20 +/-	0,5 mm	31,70	32,70
Fuselage r (profile LE to FWD of mast) in mm	158,20 +/-	1 mm	157,20	159,20
Fuselage p (max width A-A) in mm	26,40 +/-	0,5 mm	25,90	26,90
Fuselage q (max profile A-A) in mm	30,70 +/-	0,5 mm	30,20	31,20
Total weight [g]	1020,00 +/-	5 %	969,00	1071,00